

Complete folding system for quilts KA133

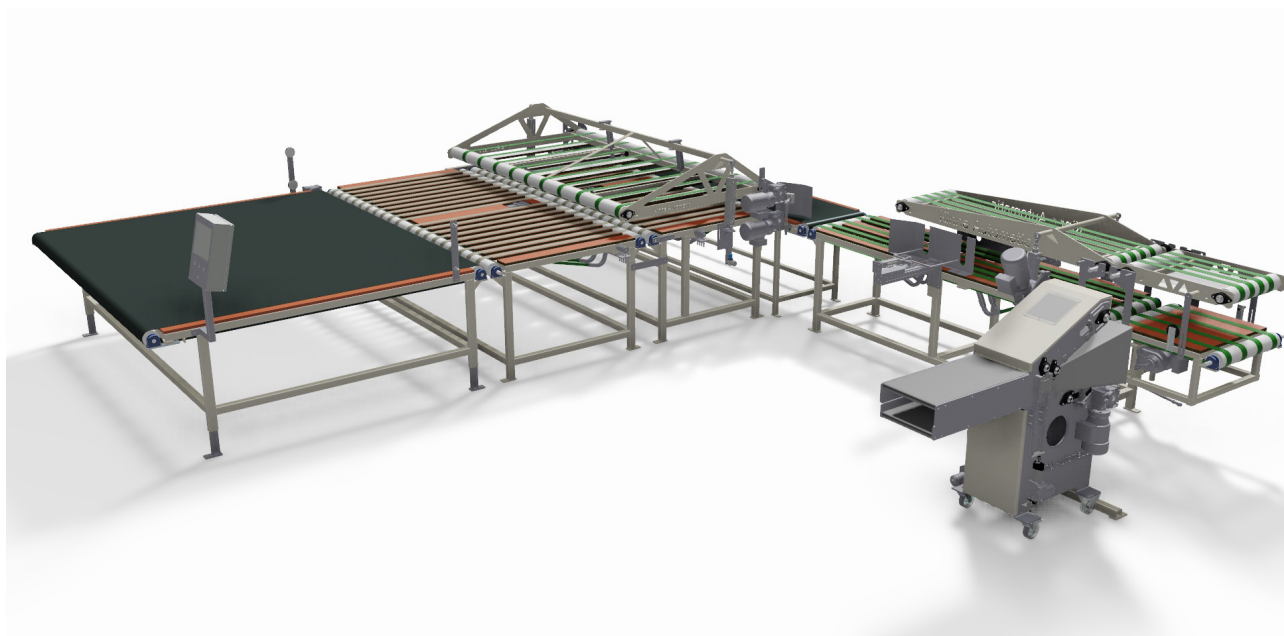

This machine first folds the quilt lengthwise and then crosswise; the finished product is then fed through a filling unit and into a bag. The folder can be used in semi-automatic mode (manual loading) or fully automatic mode in a production line.

TECHNICAL SPECIFICATION

Length x width Customized to fit clients production line

Quilts per minute Up to 6